



**2023-2024**

## **Funeral and Memorial Services**



**A place to celebrate life**





## Losing a loved one can be a very challenging time.

Planning a funeral during this period can be particularly difficult when wishes are unknown or unclear. While it's a time of grief, many important decisions need to be made.

Our experienced and compassionate team members are here to support you through it all. We understand the emotional weight you're carrying, and we're dedicated to helping you in any way we can.

There's a growing focus on celebrating the life of our loved ones as an integral part of the mourning process. We recognise the importance of incorporating elements that truly reflect the unique essence of the person we've lost, whether it's through their favourite food and wine, meaningful music, beautiful flowers, or a serene connection with nature.

We believe in empowering families and the community with transparent information, our goal is to provide knowledge, care, and compassion, ensuring everyone feels in control.

Our funeral and memorial services offer an opportunity to celebrate a life in one convenient location, within a stunning botanical park, with easy access and parking.

You're not alone in this journey. Let us walk beside you, offering warmth and understanding as we assist you to celebrate and remember your loved one in a way that truly reflects their unique life.

**Our dedicated memorial consultants are available to assist you. To arrange an appointment call our team on 08 8276 6011.**



# Jubilee Complex

Our Jubilee Complex of service spaces is a truly special place, designed to provide the perfect setting for celebrating and remembering a life. Whether you're planning an intimate memorial or large service, the beautiful Jubilee Complex can accommodate a variety of needs.

Nestled in the heart of Centennial Park, surrounded by picturesque gardens and embraced by the beauty of wisteria vines, our Jubilee Complex offers a range of unrivalled spaces and chapels that can be tailored to meet the diverse needs of families like yours. We understand that every individual is unique and their celebration and farewell should reflect their individuality.

Our Jubilee Complex is equipped with state-of-the-art audio-visual technology, ensuring that every word and moment is captured and shared. And to make it even more convenient, we offer complimentary live streaming services, allowing those who can't attend in person to be a part of the commemoration. All our spaces are suitable for both religious and non-religious services.

At Centennial Park, we're here to provide you and your family with the support you need. Our goal is to ensure that every aspect of the celebration and farewell is thought through, to create a meaningful and inclusive event that truly reflects the life and connections of your loved one.

## Facilities:

- Live streaming of service in real time
- Recording of service available on prior request
- Air Conditioning
- Table for memorabilia
- Wheelchair access
- Lectern
- External speakers available
- Convenient onsite parking
- Concierge funeral service

*Your funeral,  
your way.*







### The Mawson

Step into The Mawson, a truly one-of-a-kind, intimate space where memories come alive amidst the soothing backdrop of a tranquil water feature and lush green plants. This enchanting setting, immersed in the beauty of nature, creates a serene and comforting atmosphere to bid a heartfelt farewell to your loved one. The Mawson is ideal for smaller services, seating up to 30 people.

The Mawson and Function Room **\$650**

The Mawson (no Function Room) **\$750**

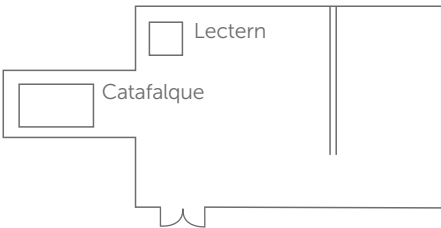

### Seating

30 People  
5 rows with 6 chairs in each

*Our Function Rooms are also available for funeral or memorial services. For information about the quality catering options within our Function Rooms, please see our Functions and Catering brochure.*



### The Florey

Welcome to The Florey, a space that beautifully blends tradition with contemporary style. This space has been thoughtfully designed to provide a peaceful and inviting atmosphere, allowing you and up to 90 guests to come together in comfort. The Florey sets the stage for a heartfelt tribute, where stories are shared, memories are cherished and a life is celebrated.

The Florey and Function Room **\$700**

The Florey (no Function Room) **\$850**



### Seating

90 People  
9 rows with 10 chairs in each



### The Heysen

Enter The Heysen, where uplifting light and spaciousness come together. This magnificent space is bathed in natural light, thanks to the beautifully crafted leadlight that adorns the room. Designed to accommodate larger gatherings, comfortably seating up to 230 people across its two levels, providing ample space for family, friends and community to come together.

The Heysen and Function Room **\$1,050**

The Heysen (no Function Room) **\$1,300**

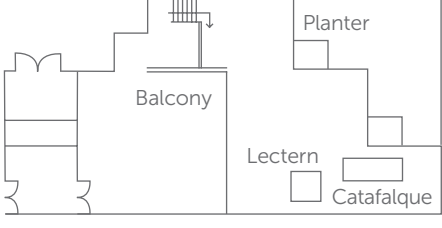

### Seating

230 People  
Ground floor: 13 church pews  
Upper floor: 5 rows with walkway in the middle



### Jubilee Complex Foyer

Be captivated by the sheer beauty of our Jubilee Complex Foyer, a versatile and stunning space that exudes grandeur and elegance. Framed with wisteria vines, it offers the perfect backdrop for a celebration of life.

On its own, the Jubilee Complex Foyer can accommodate up to 450 people. Chair layout is dependent on guest numbers. Combined with other service spaces, the Jubilee Complex Foyer can accommodate up to 770 people.

The Jubilee Complex Foyer and Function Room **\$3,500**

The Jubilee Complex Foyer (no Function Room) **\$2,750**

### SEATING

up to 450 People  
Chair layout is dependent on guest numbers.

### Jubilee Complex Foyer and The Heysen

Comfortably seat up to 680 people.

The Jubilee Complex Foyer and The Heysen with Function Rooms **\$4,750**

The Jubilee Complex Foyer and The Heysen (no Function Room) **\$3,750**

### Jubilee Complex Foyer, The Heysen and The Florey

Comfortably seat up to 770 people.

The Jubilee Complex Foyer, The Heysen and The Florey with Function Rooms **\$5,250**

The Jubilee Complex Foyer, The Heysen and The Florey (no Function Room) **\$4,250**



### Garden Services

An outdoor garden service can be held under the welcoming embrace of the Charles Newman Arbour, nestled right next to our exquisite premium rose garden. This idyllic setting offers a soothing and natural backdrop, perfect for celebrating and farewelling your loved one's life in a peaceful and serene environment.

The Charles Newman Arbour is a versatile space that can comfortably accommodate up to 100 people. Available during daylight savings only.

Charles Newman Arbour **\$1,200**





Live Streaming

**Fixed Camera**  
Live streaming of a service, with a fixed camera view, is complimentary with bookings for The Mawson, The Florey and The Heysen. Includes three months online access to the recorded service.

DVDs can be arranged at an additional cost.

**Roaming Camera**  
Live streaming of a service with a roaming camera view includes a camera operator who will move around to capture multiple views for a service of up to 1.5 hours. Includes three months online access to the recorded service.

Roaming Camera \$600

**Sundry**  
One DVD and one high-definition movie file on USB.

DVD (1) and USB (1) \$80

Surcharges

Overtime fee	
This fee is effective for every 30 minutes or part thereof starting from 30 minutes after the booking time for services in the Jubilee Complex that fall outside of the allocated booking times.	\$250
Saturday Surcharge	
Jubilee Complex	\$750
Sunday Surcharge	
Jubilee Complex	\$1,250

Viewings

The Mawson can be booked for a viewing and/or Rosary.

A Function Room and catering may be booked for before or after the viewing, prayers or Rosary, subject to availability.

Daytime Viewing	
Available between 9am and 4:30pm.	
30 Minute	\$250
60 Minute	\$450
Evening Viewing	
Available at 6pm.	
60 Minute	\$450
60 Minute with overnight coffin care at Centennial Park (if the service is the following day)	\$505

Function Rooms

Steps away from our Jubilee Complex, Centennial Park Function Rooms are a bright, contemporary calm space. The rooms can be used independently or opened up to one large space.

See our Function and Catering Brochure for more details.

Function Room	Capacity	Price
Booking one room only	80	\$420
Booking two rooms opened as one space	160	\$560
Booking three rooms opened as one space	230	\$630

Booking Times

The Mawson Seats 30	The Florey Seats 90	The Heysen Seats 230
Time	Time	Time
Service	Service	Service
9.00	9.00	9.00
10.00	9.15 - 10.30	
11.00	11.00 - 12.15	9.30 - 11.00
12.00	12.00	11.30 - 1.00
1.00	12.45 - 2.00	1.00
2.00	2.30 - 3.45	2.00
3.00	4.15 - 5.30	3.00
4.00		4.00
5.00	Twilight Service	5.00
6.00		6.00
7.00		7.00

Jubilee Complex Foyer* Seats up to 450 people	Jubilee Complex Foyer plus The Heysen* Seats up to 680 people	Jubilee Complex Foyer plus The Heysen & The Florey* Seats up to 770 people
Time	Time	Time
Service	Service	Service
3.00	3.00	3.00
3.30	3.30	3.30
4.00	4.00	4.00
4.30	4.30	4.30
5.00	4.00 - 6.00	4.00 - 6.00
5.30		
6.00		
6.30	6.30 - 8.30	6.30 - 8.30
7.00		
7.30		
8.00		
8.30		
9.00		

Burial Booking*		
Time	Time 1	Time 2
9.30		
10.00	9.30 - 10.15	
10.30		10.00 - 10.45
11.00	10.30 - 11.15	
11.30		11.00 - 11.45
12.00	11.30 - 12.15	
12.30		12.00 - 12.45
1.00	12.30 - 1.15	
1.30		1.00 - 1.45
2.00	1.30 - 2.15	
2.30		2.00 - 2.45
3.00	2.30 - 3.15	
3.30		3.00 - 3.45
4.00	3.30 - 4.15	
4.30		4.00 - 4.45
5.00		

\*A Function Room is available to book with a service. For information about the quality catering options within our Function Rooms, please see our Functions and Catering Brochure.

All prices and fees include GST where applicable and are effective from 1 July 2023.

While every effort has been made to ensure that the information in this guide is true and correct at the time of printing, Centennial Park reserves the right to make changes and will update the digital version on our website with these changes.





## Notes

## Appointment Details

For:

Consultant:

Date:

Time:

Location:





760 Goodwood Road Pasadena SA 5042  
08 8276 6011 [enquiry@centpark.org.au](mailto:enquiry@centpark.org.au)  
[www.centennialpark.org](http://www.centennialpark.org) [facebook.com/centennialparkcemetery](https://www.facebook.com/centennialparkcemetery)